



Mufledrain Slope
Drainage channel

Mufledrain Slope: highways drainage system management of surface water

Effective management of surface water for all highways and trunk roads is essential for safe use by both vehicles and pedestrians. MUFLE understands these demanding operational challenges and the importance of delivering high-performance surface water management systems.

MUFLE provides with SLOPE channel of highways-specific drainage solutions that support essential road drainage infrastructure in highways, trunk roads, urban roads, footpaths and highways conservation.

Main features

- The channel body is completely made of HD-PE, certified for load class D400 according to EN 1433: 2002
- Galvanized steel rail are standard for this product (stainless steel on request)
- Available in two different nominal widths: 100, 150 and 200 mm
- With vertical and lateral knockouts
- Vertical outlet Ø200 and Ø160 mm
- Sump unit available
- Fast fixing systems with 4 hook lock each grating.



System overview

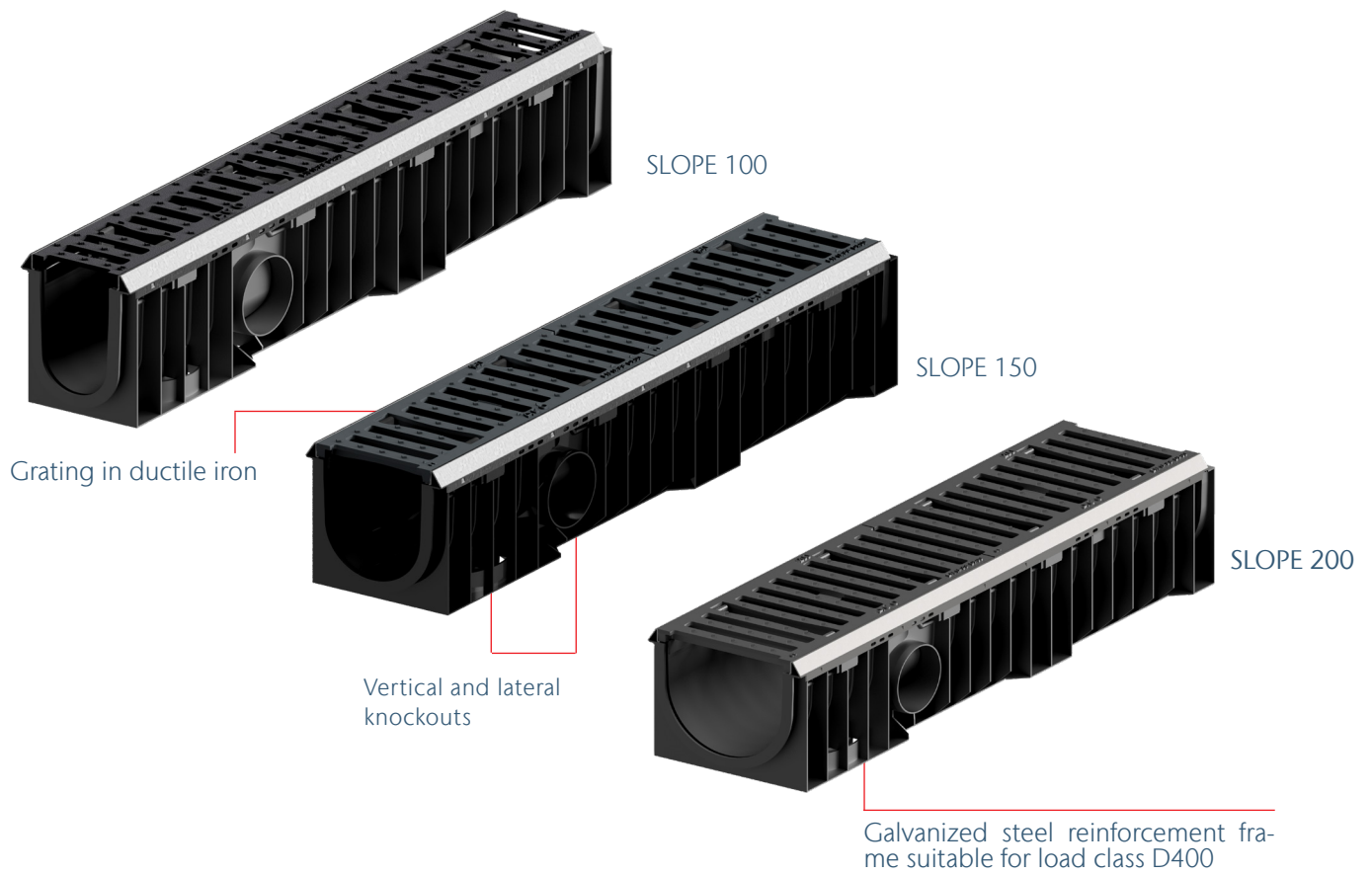

Typical applications

- Highways
- Roads
- Installation in asphalt paving

Mufledrain Slope 100

Product information

- HD-PE drainage channel, internal width: 100 mm
- Galvanized steel
- Load class D400, according to EN 1433
- Sump unit
- Side and vertical knockouts
- Hook lock fixing system for gratings



Mufledrain Slope 100 channel **combined with** grating

Length 1000 mm, total width 159 mm

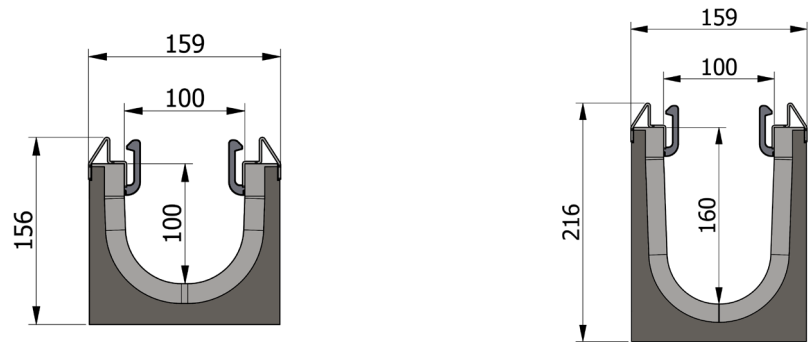





Mufledrain Slope **100/100** channel combined with grating

Image	Description	Fixing System	Width	Length	Slot/Mesh	Weight	Article number
			[mm]	[mm]	[mm]	[kg/pc]	
D 400							
	Ductile iron 20 mm Slot	Hook lock	125	500	20	10,70	809503

Mufledrain Slope **100/160** channel combined with grating

Image	Description	Fixing System	Width	Length	Slot/Mesh	Weight	Article number
			[mm]	[mm]	[mm]	[kg/pc]	
D 400							
	Ductile iron 20 mm Slot	Hook lock	125	500	20	11,20	809501

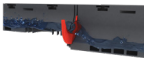
Mufledrain Slope 100 channel accessories

Image	Description	For channel internal height [mm]	Material	Article number
	Closed end-cap	100	PE	700510
		160	PE	700511
	Ø75 outlet end-cap	100	PE	700522
		160	PE	700523
	Step connectors from 100 mm to 160 mm	-	Composit	700516
	Bituminous sealant	-	-	500345

Mufledrain Slope 100 sump unit with galvanized steel rail

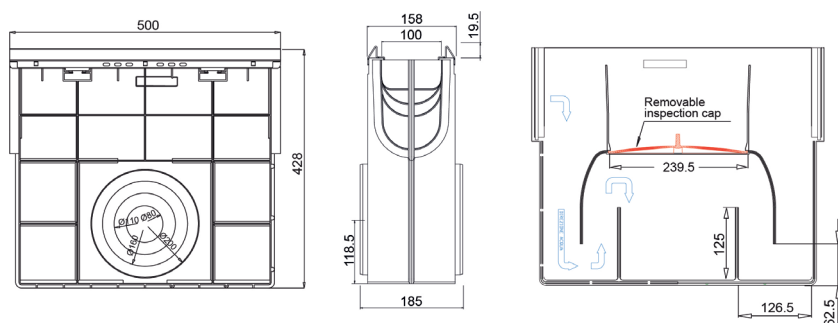

Description	Material	Height [mm]	Width [mm]	Length [mm]	Ø side outlet [mm]	Weight [kg/pc]	Galvanized steel Article number
Sump unit with female-female connection	PE	435,5	158	500	2xØ110 2xØ160 2xØ200	7,00	709043

Mufledrain Slope 150

Product information

- HD-PE drainage channel, internal width: 150 mm
- Galvanized steel
- Load class D400, according to EN 1433
- Sump unit
- Side and vertical knockouts
- Hook lock fixing system for gratings

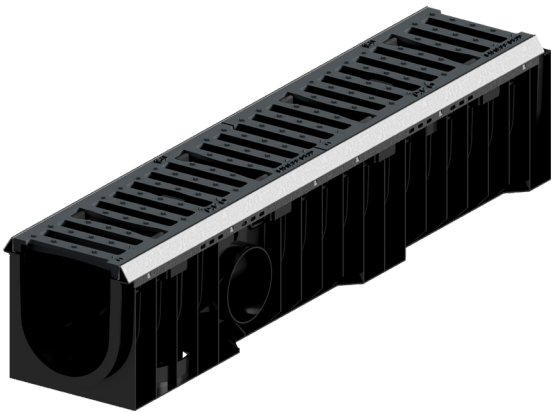

Mufledrain Slope 150 channel **combined with** grating

Length 1000 mm, total width 209 mm

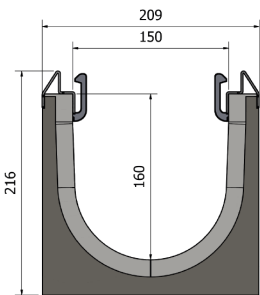
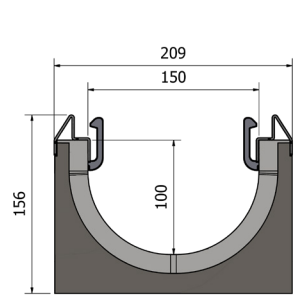





Mufledrain Slope **150/100** channel combined with grating

Image	Description	Fixing System	Width	Length	Slot/Mesh	Weight	Article number
			[mm]	[mm]	[mm]	[kg/pc]	
D 400							
	Ductile iron 20 mm Slot	Hook lock	175	500	20	14,50	809S11

Mufledrain Slope **150/160** channel combined with grating

Image	Description	Fixing System	Width	Length	Slot/Mesh	Weight	Article number
			[mm]	[mm]	[mm]	[kg/pc]	
D 400							
	Ductile iron 20 mm Slot	Hook lock	175	500	20	15,05	809S09

Mufledrain Slope 150 channel accessories

Image	Description	For channel internal height [mm]	Material	Article number
	Closed end-cap	100	PE	700512
		160	PE	700513
	Ø75 outlet end-cap	100	PE	700524
	Ø110 outlet end-cap	160	PE	700505
	Step connectors from 100 mm a 160 mm	-	Composit	700517
	Bituminous sealant	-	-	500345

Mufledrain Slope 150 sump unit with galvanized steel rail

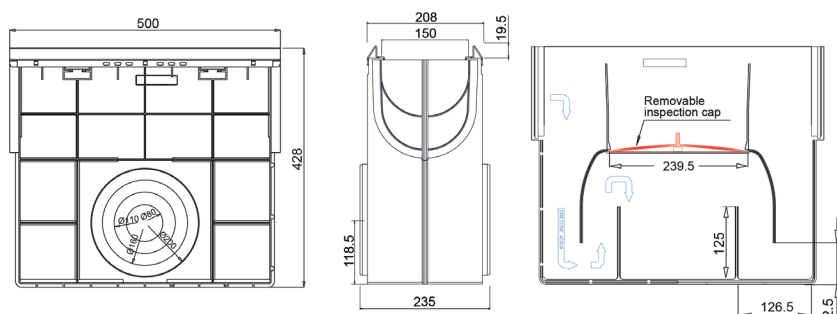

Description	Material	Height [mm]	Width [mm]	Length [mm]	Ø side outlet [mm]	Weight [kg/pc]	Galvanized steel Article number
Sump unit with female-female connection	PE	435,5	208	500	2xØ110 2xØ160 2xØ200	9,00	709044

Mufledrain Slope 200

Product information

- HD-PE drainage channel, internal width: 200 mm
- Galvanized steel rail
- Load class D400, according to EN 1433
- Side and vertical knockouts
- Hook lock fixing system for gratings



Mufledrain Slope 200 channel **combined with** grating

Length 1000 mm, total width 259 mm

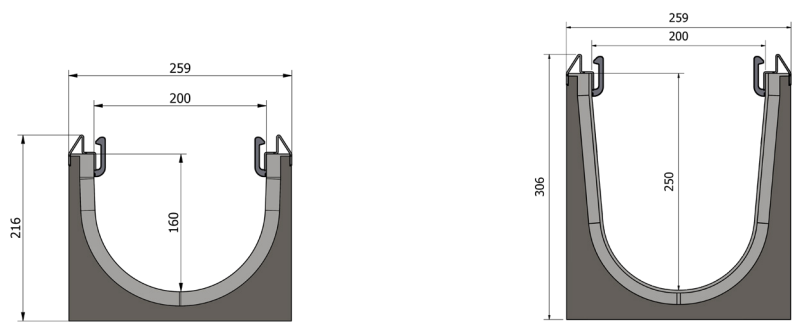



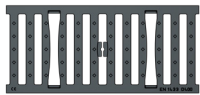

Mufledrain Slope **200/160** channel combined with grating

Image	Description	Fixing System	Width	Length	Slot/Mesh	Weight	Article number
			[mm]	[mm]	[mm]	[kg/pc]	
D 400							
	Ductile iron 20 mm Slot	Hook lock	225	500	20	19,25	809513

ACO Xtraline V **200/250** channel combined with grating

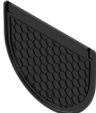
Image	Description	Fixing System	Width	Length	Slot/Mesh	Weight	Article number
			[mm]	[mm]	[mm]	[kg/pc]	
D 400							
	Ductile iron 20 mm Slot	Hook lock	225	500	20	20,70	809517

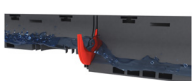
Mufledrain Slope 200 channel accessories

Image	Description	For channel internal height [mm]	Material	Article number
	Closed end-cap	160	PE	700515
	Ø110 outlet end-cap	160	PE	700507
	Closed end-cap with Ø160 knockout	250	PE	502416
	Step connectors from 200 mm to 250 mm	-	Composit	700518
	Bituminous sealant	-	-	500345

Mufledrain Slope 200 sump unit with galvanized steel rail

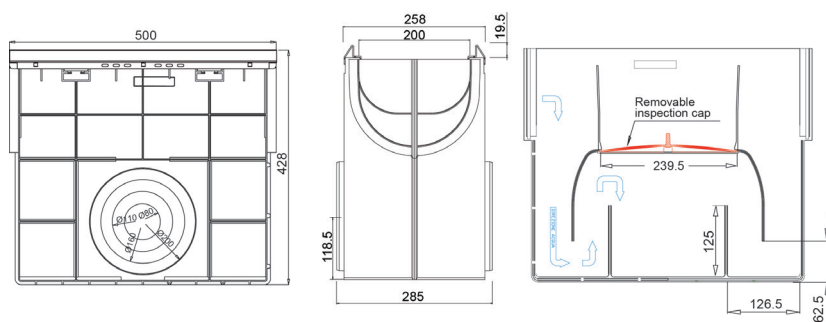

Description	Material	Height [mm]	Width [mm]	Length [mm]	Ø side outlet [mm]	Weight [kg/pc]	Galvanized steel Article number
Sump unit with female-female connection	PE	435,5	258	500	2xØ110 2xØ160 2xØ200	11,30	709045

⁽¹⁾It is not designed for connection to H250 channels