



4ALL

MUFLE
PASSION FOR DRAINAGE



DoP0011

Code
513000

Rev. 00

PE-PP Channel 4All 100/70

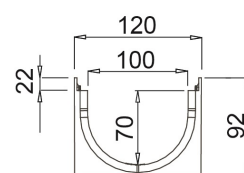
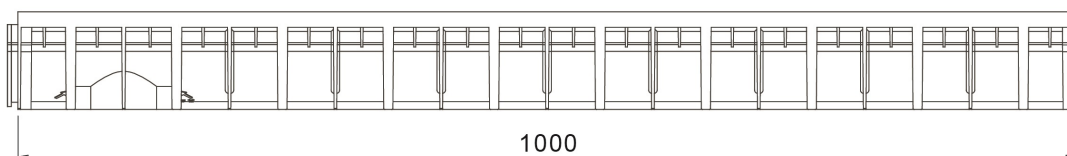
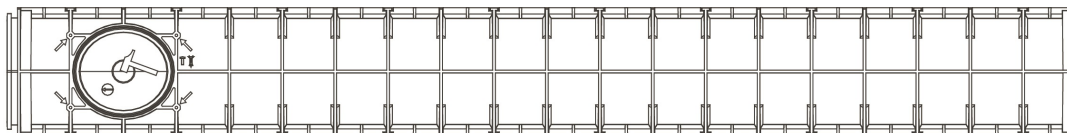

Watertight: to ensure the watertight of the channels, it is advisable to use a bituminous sealing adhesive. As a complete and long lasting guarantee of the absence of leakages through the joints of the channels, it is possible to heat-weld the joints.

Dimensions and Features

N.B. Le dimensioni sono soggette alle normali tolleranze di fabbricazione

Length (mm)	1000
External width (mm)	120
External height (mm)	92
Internal width (mm)	100
Internal height (mm)	70
Outlets	Bottom Outlet $\varnothing 100/110 - \varnothing 75$
Material	PE-PP
Weight (Kg)	0.88
Drainage section (cm ²)	56.43
Capacity (dm ³ = litri)	5.64

Compatible Gratings

Slotted	Galv. Steel/St. Steel	Load class A15
Slotted	PE	Load class A15
Slot 6mm	Ductile iron	Load class B125

The products have to be installed according to MufleSystem's specification (available on our web site)

azienda certificata ISO 9001:2015
numero verde fax 800 234495

MufleSystem s.r.l. - via dell'Industria, 7 - 62017 Porto Recanati - MC - Italy - tel. +39 071 9799122 - fax +39 071 7592275 - info@mufle.com - www.mufle.com
p.iva.it 01678850437 - cod. fisc. 01678850437 - cap. soc. € 500,000,00 interamente versato - C.C.I.A.A. MC 01678850437 - REA n. 172231