



DoP0003

Code
503008
503009

Rev. 00

HD-PE Channel WING 150/40

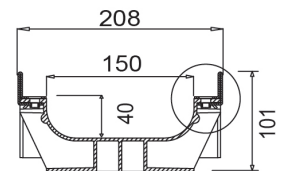
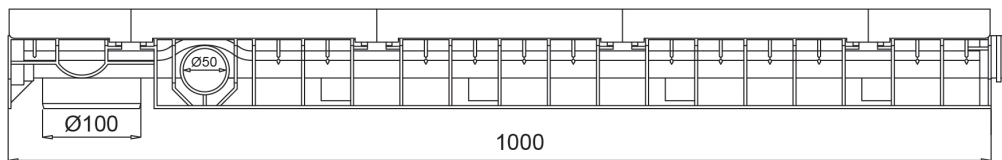
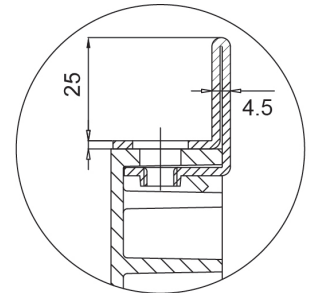
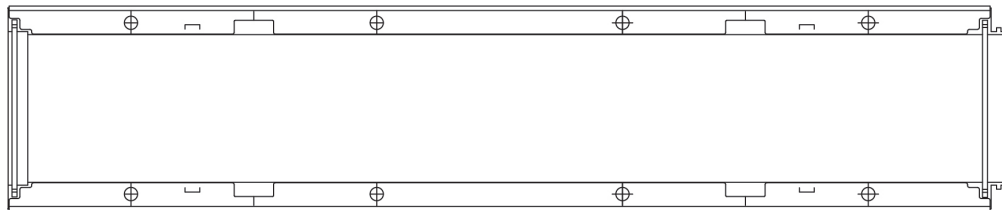

Watertight: to ensure the watertight of the channels, it is advisable to use a bituminous sealing adhesive. As a complete and long lasting guarantee of the absence of leakages through the joints of the channels, it is possible to heat-weld the joints.

Dimensions and features

N.B. Dimensions and weights are subjected to the normal tolerances of the manufacturing

Length (mm)	1000
External width (mm)	208
External high (mm)	101
Internal width (mm)	150
Internal height (mm)	40
Outlets	2xØ50 (lateral), 1xØ100 (bottom)
Material	HD-PE
Weight (Kg)	4.70
Drainage section (cm ²)	56.50
Capacity (dm ³ = litri)	5.65

Compatible Gratings

Mesh 33x11	Galvanized Steel / Stainless Steel	Load class C250
Mesh 33x33	Galvanized Steel / Stainless Steel	Load class C250
Slot 20 mm	Ductile Iron	Load class C250 - D400 - E600 - F900
Mesh	Ductile Iron	Load class D400
Solid top cover	Ductile Iron	Load class E600
Longitudinal slot "T"/"L"	Galvanized Steel / Stainless Steel	Variable
Air System	Ductile Iron	Load class E600

The products have to be installed according to MufleSystem's specification (available on our web site)

azienda certificata ISO 9001:2015
numero verde fax 800 234495

MufleSystem s.r.l. - via dell'Industria, 7 - 62017 Porto Recanati - MC - Italy - tel. +39 071 9799122 - fax +39 071 7592275 - info@mufle.com - www.mufle.com
p.iva it 01678850437 - cod. fisc. 01678850437 - cap. soc. € 500,000,00 interamente versato - C.C.I.A.A. MC 01678850437 - REA n. 172231