

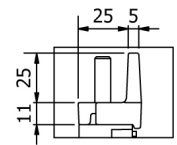

HD-PE Channel Wing G 100/80

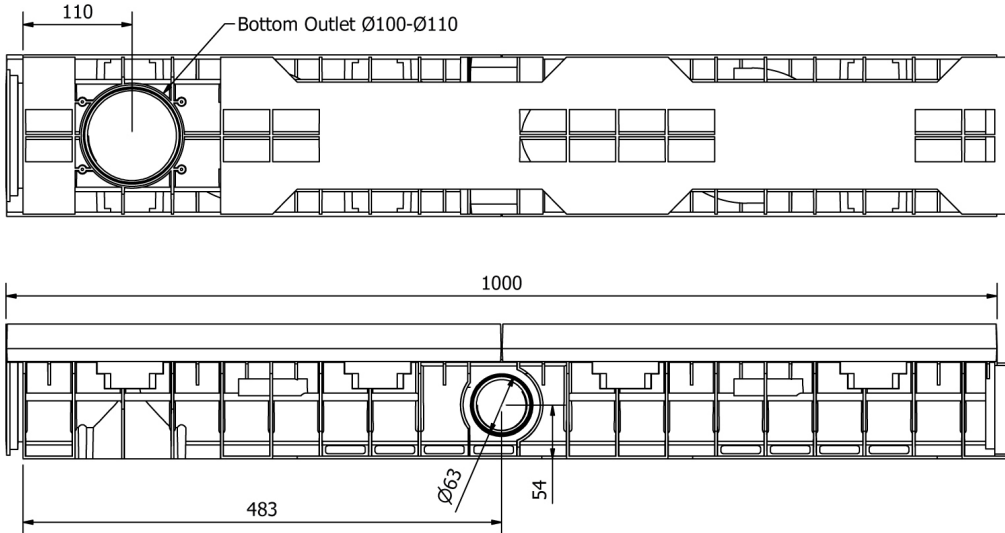

DETAIL A

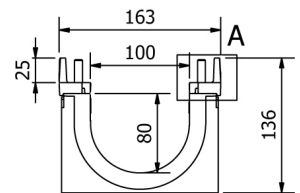

Watertight: to ensure the watertight of the channels, it is advisable to use a bituminous sealing adhesive. As a complete and long lasting guarantee of the absence of leakages through the joints of the channels, it is possible to heat-weld the joints.

Dimensions and features

N.B. Dimensions and weights are subjected to the normal tolerances of the manufacturing

Length (mm)	1000
External width (mm)	158
External high (mm)	127
Internal width (mm)	100
Internal height (mm)	80
Outlets	2xØ63 (lat.) / Kit outlet Ø100/110 (vert.)
Material	HD-PE
Frame material	Ductile iron
Weight (Kg)	8.6
Drainage section (cm ²)	69.28
Capacity (dm ³ = litri)	6.7

Compatible Gratings

Slot 20 mm	Ductile Iron	Load class D 400 - E 600 - F 900
Mesh	Ductile Iron	Load class D 400